



Kate Shimwell
082 493 0273
kate@remax-
advantage.co.za

Contact RE/MAX-Advantage
(Rosebank)

011 4476763

247 Jan Smuts Avenue, Dunkeld West 2196

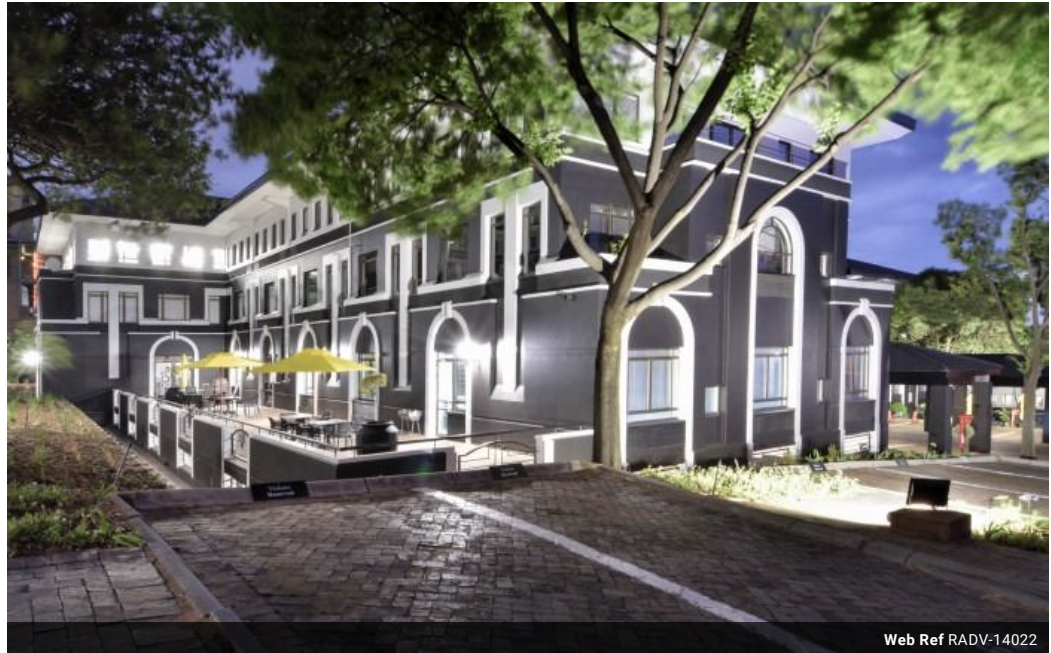

Web Ref RADV-14022



R pm

0 0

Commercial Property To Rent in Hyde Park, Sandton

172sqm Office to let in Hyde Park Lane in Hyde Park Sandton with and impressive main reception and balcony area access directly from the office. This office park has a coffee shop, fiber internet connectivity, Back-up power and water, and parking in basement, covered and open bays.

Centrally located at the intersection of Jan Smuts Avenue and William Nicol Drive Craighall. The park boasts an elegant architectural design, creating a professional environment with great security and a welcoming address. Hyde Park Corner Shopping Centre is located across the...

Features

Zoning Commercial

Sizes

Floor Size 172m²
Land Size 172m²